

# CAT® SELF-SERVICE OPTIONS

420D/E/F: BACKHOE LOADER ENGINE REBEARING & RESEAL KIT

Maintaining your engine is critical to your machine's overall performance. To minimize risk of extended downtime and failure, an Engine Rebearing and Reseal provides extended protection to mating parts and can also restore performance that your engine may have lost over time.

Our Engine Rebearing and Reseal kit is a comprehensive repair package with everything you need to perform the repair yourself. From warning signs to look for to step-by-step repair instructions, we have you covered.

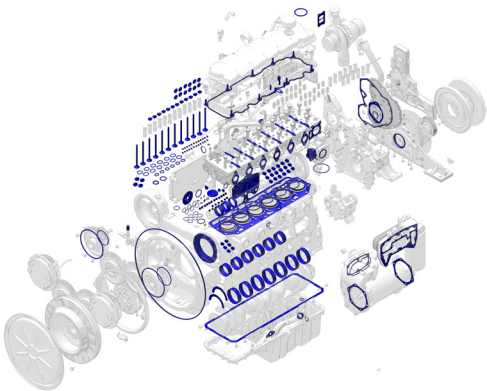

## Warning signs

Watch for these common repair indicators

- >> Excessive Blowby
- >> Loss of Power
- >> Excessive smoke
- >> Engine Noise
- >> Debris in Oil Filter
- >> Presence of abnormal wear in S•O•S<sup>SM</sup>



## Elements of the Engine Rebearing and Reseal Kit

### Customizable Parts List

- >> Pistons & Rings Sets
- >> Main & Rod Bearings
- >> Crankshaft thrust Plates
- >> Exhaust and Intake Valves
- >> Valve Guides
- >> Gasket and seal kits
- >> Oil, Fuel and Air filters
- >> Air filter indicator

### Recommended Tools

- >> Tamper Resistant Tool Group
- >> Valve Spring Compressor
- >> Inlet and Exhaust Valve Seat Extractor
- >> Puller Handle
- >> Valve Seat Driver
- >> Camshaft Bearing Tool Group
- >> Ratchet Wrench
- >> Retaining Ring Pliers
- >> Rear Seal Installer
- >> Alignment Tool
- >> Ridge Reamer
- >> Piston and Ring Compressor
- >> Ring Expander
- >> Liner Projection Tool Group
- >> Front Seal Installer

### Additional Options

- >> Replacement Turbocharger
- >> Cooling System tune-up kit
- >> Fuel System tune-up kit
- >> Electrical System repair
- >> Hydraulic System repair

### Repair Instructions

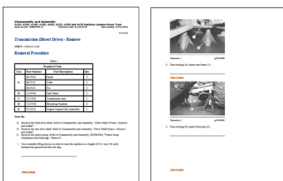

**BUILT FOR IT.™**

[www.cat.com](http://www.cat.com)

© 2017 Caterpillar • All Rights Reserved • Printed in USA  
CAT, CATERPILLAR, BUILT FOR IT, their respective logos, "Caterpillar Yellow," the "Power Edge" trade dress as well as corporate and product identity used herein, are trademarks of Caterpillar and may not be used without permission.

