

Grapples

Industrial and Utility
Buckets and Forks



Skid Steer Loader Work Tools

	Width
Industrial Grapple Buckets	1524 mm - 1829 mm (60 in - 72 in)
Industrial Grapple Forks	1676 mm & 1829 mm (66 in & 72 in)
Utility Grapple Buckets	1676 mm & 1829 mm (66 in & 72 in)
Utility Grapple Forks	1676 mm & 1829 mm (66 in & 72 in)

Cat® Industrial and Utility Grapple Buckets and Forks

Designed to handle a wide array of materials in a variety of operating conditions.



Caterpillar® Industrial Grapple Buckets and Forks are designed to easily handle a wide array of bulky, irregularly shaped objects encountered in demolition, industrial, construction, recycling and other aggressive applications.

Industrial grapple buckets are ideal for grasping objects such as railroad ties, trees, large rocks, brush, industrial and demolition scrap, and recycling debris. Industrial grapple forks are great for piercing and grasping paper, cardboard, wood and light gauge metal scrap.

Caterpillar Utility Grapple Buckets and Forks are designed to handle light, hard to handle materials encountered on a farm, ranch or landscaping project. The light duty design offers grasping capabilities for materials such as loose hay, straw, bedding materials, dry compacted livestock waste, landscaping mulch and pine straw.

Performance and Versatility

Caterpillar Grapples deliver maximum performance, productivity and durability when coupled to Cat Skid Steer Loaders. Designed and built to strict Caterpillar standards, they carry with them the proven Caterpillar reputation for performance, versatility and reliability.

Ease of Operation

Cat Grapples are designed with the operator in mind. The coupler interface is matched to the Cat Skid Steer Loader's mechanical quick coupler system for fast, secure work tool changes. Hydraulic hose routing, hose length and quick disconnects have been optimized to ensure proper routing and fit-up. Steps are conveniently located to facilitate operator entry and exit. Operation of Cat Industrial Grapples is easy with Caterpillar joystick controls...virtually everything is at your fingertips.

Industrial and utility grapples are designed to use the skid steer loaders' standard flow auxiliary hydraulic circuit and horsepower capabilities.

Features

Industrial Grapple Buckets and Forks

- **Designed for maximum performance in aggressive applications.** Heavy-duty construction provides superior structural durability in aggressive conditions encountered in demolition, construction and recycling. Caterpillar Industrial Grapple Buckets incorporate a durable steel bucket, dual full width torque tubes and two vertical reinforcing gussets. Caterpillar Industrial Grapple Forks incorporate a durable steel fork carriage, a full width upper torque tube and a series of internal reinforcing gussets. Both grapple types include two high strength steel grapple assemblies for superior durability and bending resistance.
- **Excellent clamping force and independently controlled grapple assemblies** allow for grasping of irregularly shaped objects, increasing the versatility of the machine.

Utility Grapple Buckets and Forks

- **Designed for light duty material handling.** Lighter duty construction provides an economical means for handling light, hard to handle material encountered in agriculture and landscaping. Caterpillar Utility Grapple Buckets are constructed from utility buckets and use a single, full width bolt-on grapple assembly with center-mounted cylinder and four gusseted tines. Cat Utility Grapple Forks use the same bolt-on grapple assemblies but are built off the utility fork. The multi-tined utility grapple fork carriage incorporates a predrilled, full width upper torque tube and three lower gussets to protect against twisting. The lower box channel is predrilled to accept various combinations of pin-on fork tines. A bolt-on rubber bumper limits rack back travel on Caterpillar 236, 246 and 248 machines.

- **Bolt-on grapple assembly** can be easily removed or installed when the need arises. The grapple assembly can be added to existing utility buckets and forks for added versatility.

Common Features

- **Wide vertical jaw opening** allows for handling of large, bulky material. Industrial grapple buckets are capable of carrying standard industrial drums in the upright position. Industrial grapple forks can easily handle pierceable objects. Utility grapple buckets and forks are ideal for handling bundled material, loose straw and hay, landscaping pine straw and manure. Note: Utility grapple forks are not designed for piercing and carrying large, round bales.
- **Hinge pins, cylinder pins and hardware** are plated for corrosion protection and long life. Grease points are conveniently located and protected.
- **Hardened bucket base edge and fork tines** provide excellent penetration and wear life. Base edges are predrilled to accept bolt-on cutting edges for protection in high wear applications.
- **Caterpillar medium pressure hose, couplings and O-ring face seals** provide superior leak free performance and reliability. All hoses are wrapped with nylon woven Cordura sleeving for added operator protection. Hydraulic quick disconnects enable fast tool changes.

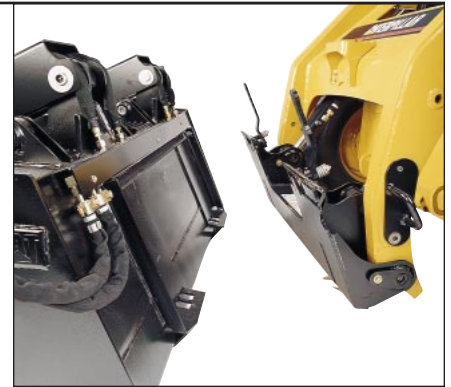

Quick Coupler

Caterpillar Skid Steer Loader Work Tools incorporate an interface that matches the Caterpillar machine's integrated mechanical quick coupler system. The rugged, opposing wedge design holds the work tool tightly and allows the operator to quickly change from one high performance Cat Work Tool to another.

Serviceability

Cat Industrial Grapples utilize proven components such as Caterpillar hose, couplings, O-ring face seals, hardware and replaceable hardened tines. A full line of replacement parts is readily available from your Cat dealer to help extend work tool system life.

Customer Support

Caterpillar is always ready to assist you in matching the right work tool to your application or machine, adding more Cat Work Tools to your lineup or obtaining responsible, knowledgeable support.

Dimensions

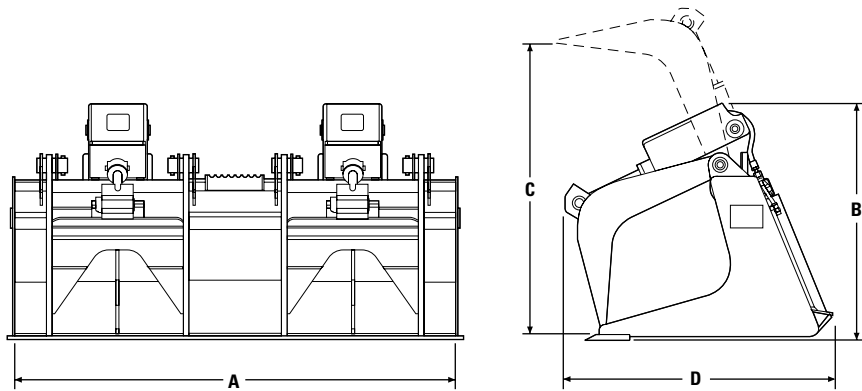

Industrial Grapple Buckets

A Width*	1524 mm (60 in)	1676 mm (66 in)	1829 mm (72 in)
B Height	813 mm (32 in)	813 mm (32 in)	813 mm (32 in)
C Jaw opening	1016 mm (40 in)	1016 mm (40 in)	1016 mm (40 in)
D Length	940 mm (37 in)	940 mm (37 in)	940 mm (37 in)
Bucket weight**	438 kg (965 lb)	451 kg (995 lb)	465 kg (1025 lb)
Sidewall thickness	10 mm (0.40 in)	10 mm (0.40 in)	10 mm (0.40 in)
Base edge thickness	19 mm (0.75 in)	19 mm (0.75 in)	19 mm (0.75 in)
Cutting edge thickness***	16 mm (0.63 in)	16 mm (0.63 in)	16 mm (0.63 in)

* Measured from inside of side plate to inside of side plate; overall width is approximately 50 mm (2 in) wider.

** With base cutting edge only, without ground engaging tools.

*** Optional bolt-on cutting edge.

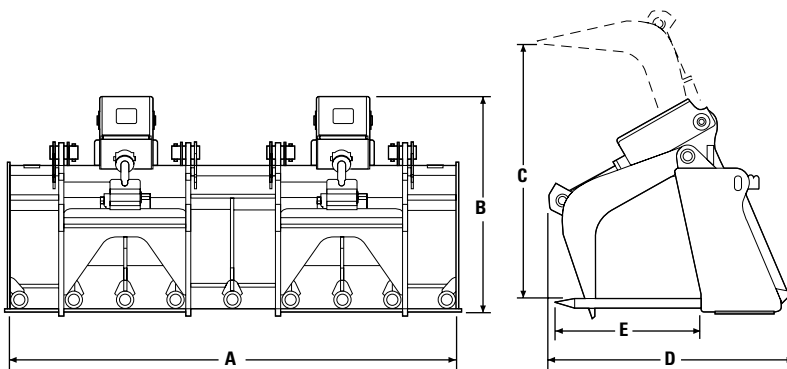

Industrial Grapple Forks

A Width*	1676 mm (66 in)	1829 mm (72 in)
B Height, grapples closed	813 mm (32 in)	813 mm (32 in)
C Jaw opening	965 mm (38 in)	965 mm (38 in)
D Length	940 mm (37 in)	940 mm (37 in)
E Exposed tine length	559 mm (22 in)	559 mm (22 in)
Weight	485 kg (1070 lb)	533 kg (1175 lb)
Tine diameter	43 mm (1.75 in)	43 mm (1.75 in)
Number of tines	9	11

* Measured from inside of side plate to inside of side plate; overall width is approximately 50 mm (2 in) wider.

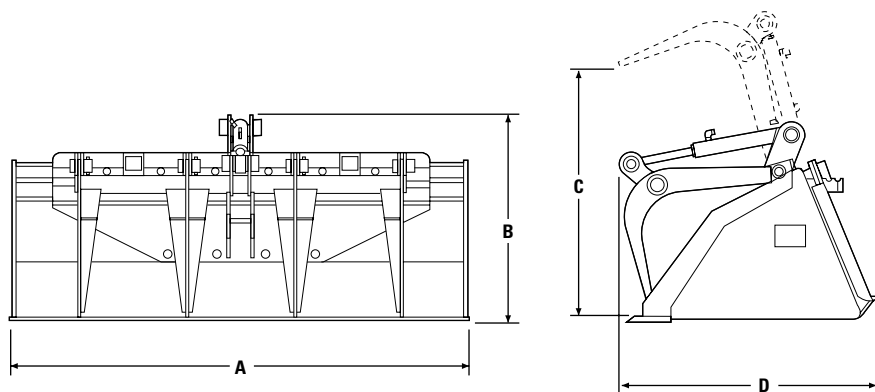

Utility Grapple Buckets

A Width*	1676 mm (66 in)	1829 mm (72 in)
B Height, grapples closed	739 mm (29 in)	739 mm (29 in)
C Jaw opening	902 mm (35.5 in)	902 mm (35.5 in)
D Length	934 mm (37 in)	934 mm (37 in)
Weight**	322 kg (710 lb)	336 kg (745 lb)
Base edge thickness	19 mm (0.75 in)	19 mm (0.75 in)
Cutting edge thickness***	16 mm (0.63 in)	16 mm (0.63 in)

* Measured from inside of side plate to inside of side plate;
overall width is approximately 50 mm (2 in) wider.

** Weight with base edge only — no ground engaging tools included.

*** Bolt-on cutting edge.

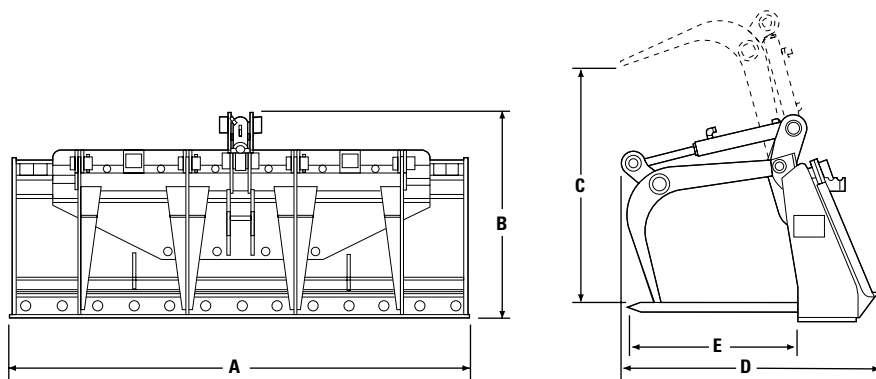

Utility Grapple Forks

A Width*	1676 mm (66 in)	1829 mm (72 in)
B Height, grapples closed	755 mm (30 in)	755 mm (30 in)
C Jaw opening	876 mm (34.5 in)	876 mm (34.5 in)
D Length	940 mm (37 in)	940 mm (37 in)
E Exposed fork tine length	627 mm (24.7 in)	627 mm (24.7 in)
Weight	290 kg (640 lb)	322 kg (710 lb)
Fork tine diameter	32 mm (1.25 in)	32 mm (1.25 in)
Number of fork tines	7	9
Total fork tine holes	13	17

* Measured from inside of side plate to inside of side plate;
overall width is approximately 50 mm (2 in) wider.

Grapples Skid Steer Loader Work Tools

Compatibility

Following are the recommended and approved Cat Skid Steer Loader/Grapple combinations for maximum system performance.

Model	Industrial Grapple Buckets		
	60"	66"	72"
216 Skid Steer Loader	●	■	▽
226 Skid Steer Loader	●	■	▽
228 Skid Steer Loader	●	■	▽
236 Skid Steer Loader	■	●	●
246 Skid Steer Loader	■	●	●
248 Skid Steer Loader			

- Provides optimum system performance.
- Provides acceptable system performance.
- ▽ Not recommended.

Model	Industrial Grapple Forks	
	66"	72"
216 Skid Steer Loader	●	▽
226 Skid Steer Loader	●	▽
228 Skid Steer Loader	●	▽
236 Skid Steer Loader	●	●
246 Skid Steer Loader	●	●
248 Skid Steer Loader		

- Provides optimum system performance.
- ▽ Not recommended.

Model	Utility Grapple Buckets	
	1676 mm (66")	1829 mm (72")
216 Skid Steer Loader	●	▽
226 Skid Steer Loader	●	▽
228 Skid Steer Loader	●	▽
236 Skid Steer Loader	●	●
246 Skid Steer Loader	●	●
248 Skid Steer Loader	●	●

- Provides optimum system performance.
- ▽ Not recommended.

Model	Utility Grapple Forks	
	1676 mm (66")	1829 mm (72")
216 Skid Steer Loader	●	▽
226 Skid Steer Loader	●	▽
228 Skid Steer Loader	●	▽
236 Skid Steer Loader	●	●
246 Skid Steer Loader	●	●
248 Skid Steer Loader	●	●

- Provides optimum system performance.
- ▽ Not recommended.

www.CAT.com

© 1999, 2000 Caterpillar
Printed in U.S.A.

AEHQ5350-01 (2-00)
(Replaces AEHQ5350)

Materials and specifications are subject to change without notice.
Featured machines in photos may include additional equipment.
See your Caterpillar dealer for available options.

CATERPILLAR®