

**Highly efficient 3-phase AC drive motor**

**Ergonomic, multi-function handle head**

**Easily maneuvered with the handle in the vertical position by pressing the crawl-speed button**

**Compact and maneuverable**

**Maintenance-free battery pack with integrated charger**

**Optional proportional lowering for exact pallet placement**



## **EMC 110 (Fork Over) / EMC B10 (Straddle)**

### **Electric Walkie Stacker (2200 lbs.)**

The EMC 110/EMC B10 electric walkie stacker combines productivity, efficiency and operator security in one user-friendly design. It is well-suited for use in a wide variety of short lift height applications, including lifting raw materials to feeder machines and stacking palletized loads onto first-level racking. In addition, it excels as an ergonomic aid, raising or lowering materials and goods to comfortable, operator-friendly working heights.

Excellent ergonomics contribute to effortless operation of the EMC/EMC B. The long, low-mounted handle promotes lower steering resistance while also keeping the operator a

comfortable distance away from the truck. The proportional lowering function (optional) ensures fragile loads are gently placed on racking or the floor. The truck's short head length of 21 inches enables the EMC/EMC B to easily turn in narrow aisles.

All travel, lift and horn functions are easily accessible from both sides of the multi-function handle head. The crawl-speed button, located on the back of the handle, acts as a brake bypass switch and allows the truck to maneuver in tight areas with the handle in the vertical position.

The EMC/EMC B offers several features that ensure excellent power management and longer operating times. The maintenance-free 2x12V, 70 Ah battery pack is easily recharged with the integrated charger, which can be connected to any 110/120V wall outlet. The battery discharge indicator continuously displays battery state-of-charge and includes a lift cut-out function when state-of-charge reaches 20%.

Jungheinrich's innovative 3-phase AC drive motor is virtually maintenance-free and provides outstanding performance for efficient, productive operation.

**JUNGHEINRICH**

# EMC 110 (Fork Over) / EMC B10 (Straddle)

EMC 110

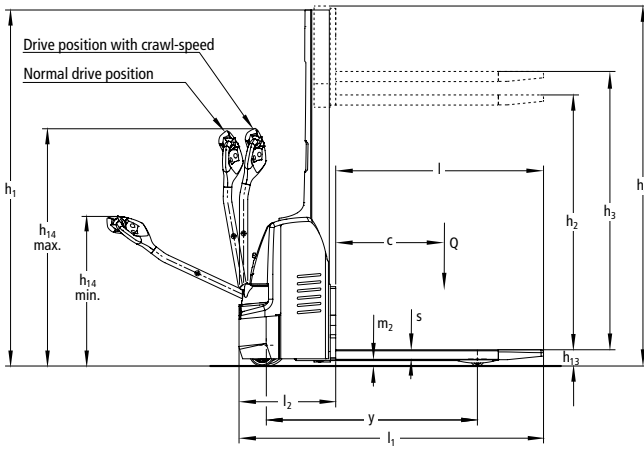

EMC B10

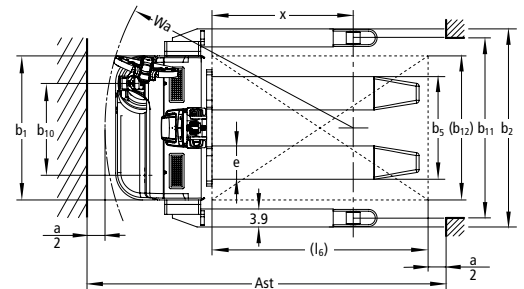
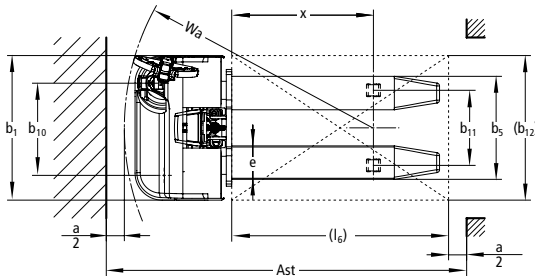
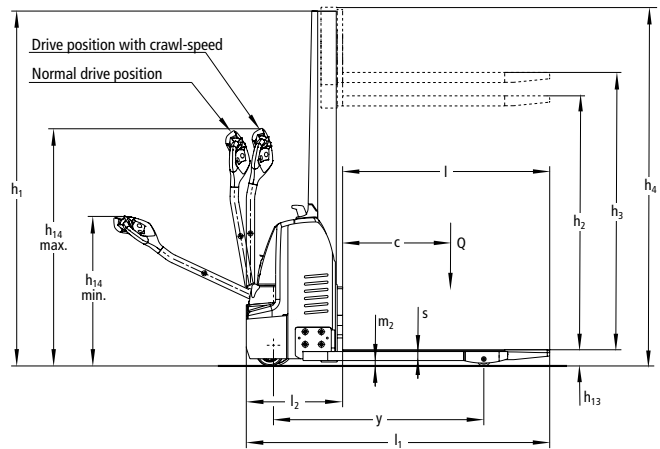

# Technical Data

as of: 01/2010

Characteristics	1.1	Manufacturer	Jungheinrich	Jungheinrich	Jungheinrich	Jungheinrich	1.1	
	1.2	Manufacturer's type designation	<b>EMC 110</b>	<b>EMC 110</b>	<b>EMC B10</b>	<b>EMC B10</b>	1.2	
	1.3	Drive	electric	electric	electric	electric	1.3	
	1.4	Type of operation	walkie	walkie	walkie	walkie	1.4	
	1.5	Load capacity/rated load	Q (lbs)	2200	2200	2200	2200	1.5
	1.6	Load center distance	c (inches)	24	24	24	24	1.6
	1.8	Load distance, center of load axle to fork face	x (inches)	30.9	30.9	30.9	30.9	1.8
	1.9	Wheelbase	y (inches)	46.0	46.0	46.0	46.0	1.9
	Weights	2.1	Service weight incl. battery (see line 6.5)	lbs	1207	1287	1479	1506
2.2		Axle loading, loaded front/rear	lbs	1224/2183	1274/2213	1280/2397	1296/2410	2.2
2.3		Axle loading, unloaded front/rear	lbs	882/320	937/346	1055/417	1071/430	2.3
Wheels / Chassis	3.1	Tires	PU (polyurethane)	PU (polyurethane)	PU (polyurethane)	PU (polyurethane)	3.1	
	3.2	Tire size, front	inches	9.1 x 2.8	9.1 x 2.8	9.1 x 2.8	9.1 x 2.8	3.2
	3.3	Tire size, rear	inches	3.0 x 2.8	3.0 x 2.8	3.0 x 2.8	3.0 x 2.8	3.3
	3.4	Additional wheels (dimensions)	inches	5.9 x 2.1	5.9 x 2.1	4.9 x 1.6	4.9 x 1.6	3.4
	3.5	Wheels, number front/rear (x = driven wheels)		1x/2	1x/2	1x/2	1x/2	3.5
	3.6	Track width, front	b <sub>10</sub> (inches)	20.1	20.1	20.1	20.1	3.6
	3.7	Track width, rear	b <sub>11</sub> (inches)	16.3	16.3	39.4/46.1/53.9	39.4/46.1/53.9	3.7
Dimensions	4.2	Collapsed mast height	h <sub>1</sub> (inches)	77.6	95.7	77.6	95.7	4.2
	4.3	Free-lift	h <sub>2</sub> (inches)	59.3	25.4 <sup>1)</sup>	59.3	25.4 <sup>1)</sup>	4.3
	4.4	Lift height	h <sub>3</sub> (inches)	60.6	78.7	60.6	78.7	4.4
	4.5	Extended mast height	h <sub>4</sub> (inches)	78.4	127.6	78.4	127.6	4.5
	4.9	Handle height in drive position min/max	h <sub>14</sub> (inches)	32.3 / 51.4	32.3/51.4	32.3/51.4	32.3/51.4	4.9
	4.15	Lowered fork height	h <sub>13</sub> (inches)	3.5	3.5	1.8	1.8	4.15
	4.19	Overall length	l <sub>1</sub> (inches)	66.3	66.3	66.3	66.3	4.19
	4.20	Length to fork face (headlength)	l <sub>2</sub> (inches)	21.1	21.1	21.1	21.1	4.20
	4.21	Overall width	b <sub>1</sub> /b <sub>2</sub> (inches)	31.5/-	31.5/-	43.3/50/57.9	43.3/50/57.9	4.21
		Inside dimension of support / straddle legs	b <sub>2</sub> (inches)	12.4	12.4	35.4/42.1/50	35.4/42.1/50	
	4.22	Fork dimensions	s/e/l (inches)	2.2/7.3/45.3	2.2/7.3/45.3	1.6/3.9/45.3	1.6/3.9/45.3	4.22
	4.24	Fork carriage width	b <sub>3</sub> (inches)	-	-	31.5	31.5	4.24
	4.25	Overall fork width	b <sub>5</sub> (inches)	22.4	22.4	12.4-27.8	12.4-27.8	4.25
	4.31	Ground clearance, loaded, under mast	m <sub>1</sub> (inches)	1.2	1.2	1.2	1.2	4.31
	4.32	Ground clearance, center of wheelbase	m <sub>2</sub> (inches)	1.2	1.2	1.2	1.2	4.32
4.33	Aisle width for pallets 48 x 40 (L x W)	Ast (inches)	87.3	87.3	87.5	87.5	4.33	
4.35	Turning radius	Wa (inches)	54.3	54.3	54.3	54.3	4.35	
Performance	5.1	Travel speed, loaded/unloaded	mph	2.6/3.1	2.6/3.1	2.6/3.1	2.6/3.1	5.1
	5.2	Lift speed, loaded/unloaded	ft/min	17.7/25.6	17.7/25.6	17.7/25.6	17.7/25.6	5.2
	5.3	Lowering speed, loaded/unloaded	ft/min	23.6/21.7	23.6 / 21.7	23.6/21.7	23.6/21.7	5.3
	5.7	Gradeability, loaded/unloaded	%	3.5/15	3.5/15	3.5/15	3.5/15	5.7
	5.10	Service brake		electric	electric	electric	electric	5.10
Motors	6.1	Drive motor rating S <sub>2</sub> 60 min	kW/HP	0.5/0.7	0.5/0.7	0.5/0.7	0.5/0.7	6.1
	6.2	Lift motor rating at S <sub>3</sub> 15%	kW/HP	1.2/1.6	1.2/1.6	1.2/1.6	1.2/1.6	6.2
	6.4	Battery voltage, nominal capacity (at 6 hour rate)	V/Ah	2 x 12/70	2 x 12/70	2 x 12/70	2 x 12/70	6.4
	6.5	Battery weight	lbs	139	139	139	139	6.5
	Other Details	8.1	Type of drive control		AC SpeedControl	AC SpeedControl	AC SpeedControl	AC SpeedControl
8.4		Sound level at the driver's ear	dB(A)	70	70	70	70	8.4

1) Includes load guard

# The Jungheinrich Advantage

## Enhanced stacking and retrieval

All lift and lower controls are easily accessible via the multi-function handle head, allowing the operator to focus entirely on stacking and retrieval. Other advantages that make these functions secure and productive include:

- Unique, single cylinder mast design for a superior view of the load.
- Offset drive unit creates higher four-point wheel stability.
- High lifting speed increases productivity.
- Precise and gentle depositing of fragile loads onto racking or the floor. The lowering speed is electro-hydraulically controlled (in 2 stages) via a button on the handle head (optional).



Compact drive unit for excellent maneuverability

## Compact design for confined space operation

The EMC B features an extremely short chassis length of 21 inches and a low chassis weight of 1301 lbs., allowing the truck to easily operate in a variety of confined space areas such as elevators and mezzanines. The truck is also equipped with a crawl-speed button. When pressed, it bypasses the brake switch and allows controlled travel with the handle in the full, vertical position.

## Ergonomic operation

The redeveloped, state-of-the-art handle head is superbly engineered to suit the ergonomic needs of the operator.

- Color scheme design promotes intuitive operation.

- Control buttons include wear-resistant indicators.
- Angle of handle conforms to natural hand position of the operator.
- Lift and lower controls combined on a rocker switch for convenient operation in any handle position.
- Centrally-located horn button is easily reached by both left and right-handed operators.

## Fork-over version (EMC 110)

- Support legs are mounted under fixed-position pallet truck type forks, reducing overall chassis width.
- Can only be used with open faced pallets or skids (no bottom boards perpendicular to forks).

## Reduced maintenance

Low maintenance components ensure significant, long-term reduction in operating costs.

- Low maintenance 3-phase AC drive motor.
- Integrated charger sealed within IP54-protected controller.
- Handle head and electrical connectors protected to IP65.
- Easy access to all components through the durable front cover.



Sealed AC motor, controllers and connectors



EMC 110 operating as a lift table

## Long operating times

The battery, when combined with energy-efficient 3-phase AC technology, provides long operating times.

- Maintenance-free 2 x 12V/70 Ah batteries.
- Integrated 115V charger and cord for fast, simple charging at any 110/120V wall outlet.

## Available options

- Truck activation via PIN (CanCode) and choice of 3 programmable performance modes.
- Enhanced information display (CanDis) with lift interrupt, hour-meter and service code display.
- 78 inch lifting height.
- 35 or 50 inch straddle leg opening (42 inch standard opening).
- 48 inch load backrest, required for 78 inch lifting height.

Built in compliance with ITSDF B56.1 design specifications\* for Type E industrial trucks with Type E battery.

\* In accordance to specifications in place at time of manufacture.



1-877-JH-FORKS

www.jungheinrich-lift.com

**JUNGHEINRICH**  
Well worthwhile